

XL/127-PLAST-ST

VERTICAL LEVEL GAUGE WITH MAXIMUM TEMPERATURE ELECTRICAL SWITCH

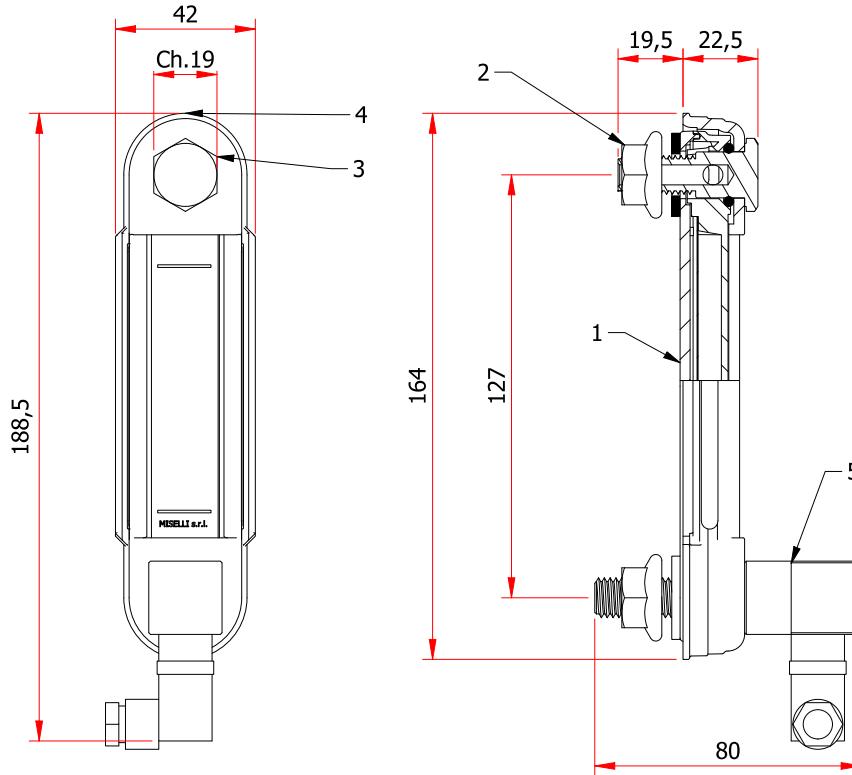

NO contact

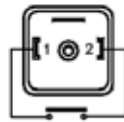

NC contact



-Preset electrical sensor with switching temperature available of **60°C/140°F** or **70°C/158°F** incorporated into the zinc plated M12 bolt with adjustable DIN connector.

-Standard executions: **XL/127-PLAST-ST-NO** (electrical contact normally open on temperature sensor) and **XL/127-PLAST-ST-NC** (electrical contact normally closed on temperature sensor).

-Operation features: the level gauge XL/127-PLAST-ST in addition to allowing a visual oil level inspection provides an electrical signal when the temperature of the fluid inside the reservoir reaches the specified preset switching temperature (in conditions of use at room temperature of 20°C/68°F). The model XL/127-PLAST-ST-NO the electrical circuit is closed once it reaches the preset specified temperature, the model XL/127-PLAST-ST-NC is open once it reaches the preset specified temperature.

COMPONENTS LIST

Item	Description
1	Transparent body
2	Flanged hex nut M12
3	Hollow bolt M12
4	Plastic guard
5	Max Temperature sensor

ELECTRICAL CHARACTERISTICS MAX TEMPERATURE ELECTRICAL SENSOR

Sensor type	Bimetal contact
Power supply	AC/DC
Electrical contact	NO Normally open NC Normally closed
Max applicable voltage	10 A / 250 Vac
Connector	Mini DIN 43650-C
Protection degree	IP65
Calibration	60°C/140°F - 70°C/158 °F
Accuracy	±5°C (data referred to a room temp. = 20°C /68°F)