

## TMDF-70 - FILLER BREATHER WITH FILTER

## TMDF-70-AS - FILLER BREATHER WITH FILTER AND INTERNAL ANTI-SPLASH



TMDF-70



TMDF-70-AS

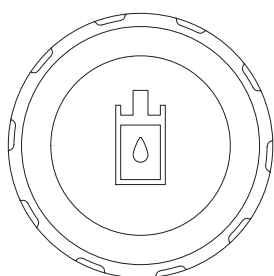
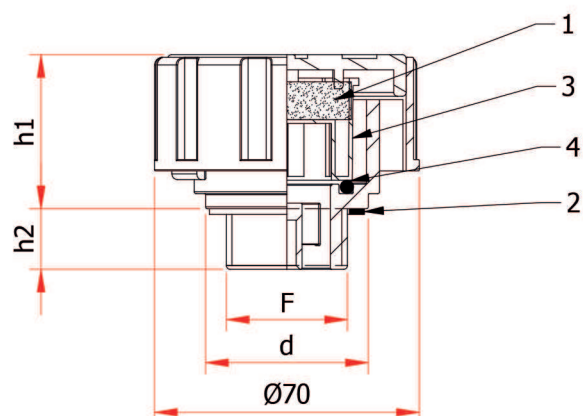
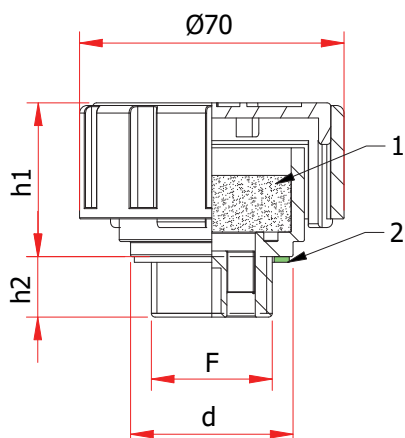

- 1 = Air filter
- 2 = NBR flat seal
- 3 = Internal anti splash
- 4 = Internal O-Ring

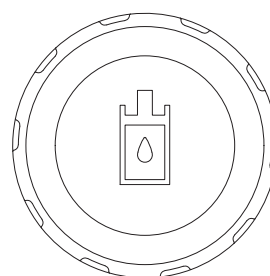

Cod.	Cod.	F	d	h1	h2	Pack.
TMDF/34/70	TMDF/34/70-AS	G 3/4"	47	41,5	15,5	10
TMDF/1/70	TMDF/1/70-AS	G.1	49	40,7	16	10
TMDF/114/70	TMDF/114/70-AS	G 1 1/4"	53	41	14,5	10
TMDF/112/70	TMDF/112/70-AS	G 1 1/2"	43	41	14,5	10
TMDF/2/70	TMDF/2/70-AS	G.2"	69	42	16	10
TMDF/56.4/70	TMDF/56.4/70-AS	56x4	69	42	16	10

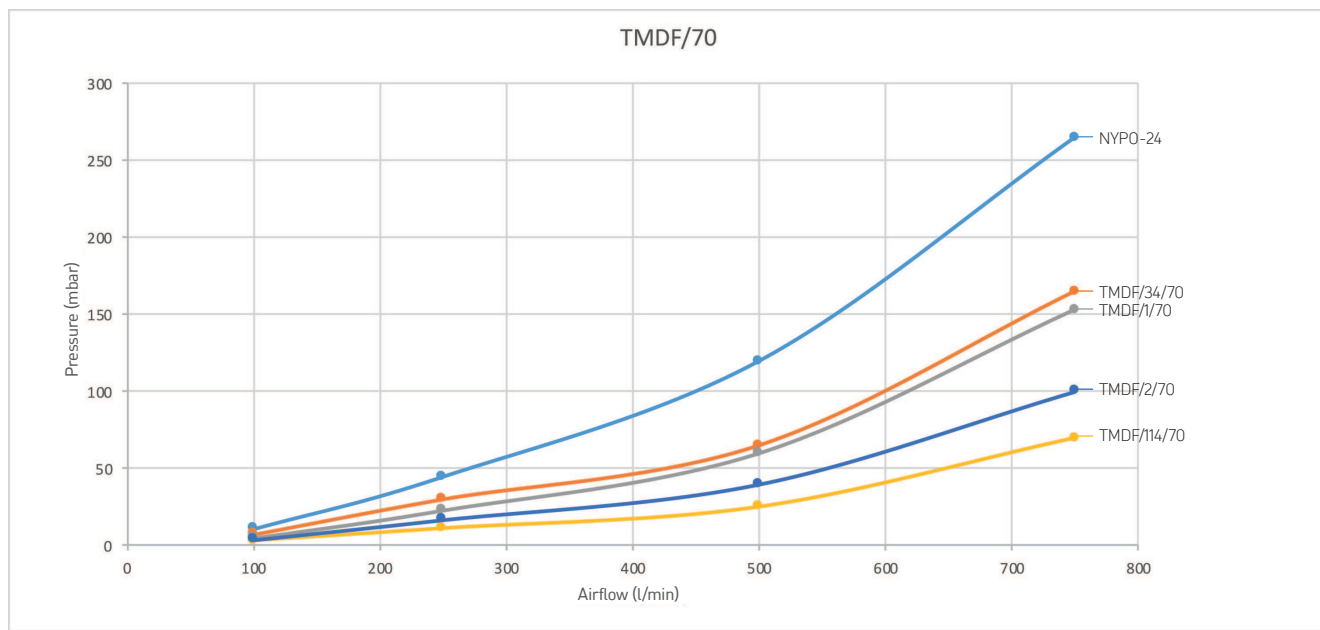

Threaded filler breather, cylindrical head 70 mm  $\varnothing$ , with easy grip vertical ribs, ensuring high mechanical resistance at both low and high temperatures, dimensional stability and shocks resistance, designed for applications where is required a large capacity of air flow as hydraulic tanks subject to rapid changes in the internal fluid volume.

- Material:** Polyamide PA66.
- Sealing:** flat gasket NBR 70 Shore.
- Maximum working temperature:** 100°C/212°F.
- Filter:** polyurethane foam filter element.
- Internal anti-splash:** version -AS (blue lid) with internal anti-splash system suggested for mobile applications or where the fluid inside is subjected to strong movements.
- Airflow capacity:** up to 750 Liters/min (see data and graphic).